



Measurement Specialist »gemini«

Simple Measurement of Crankshaft Milling Cutters

Highlights

- Ergonomic
Ergonomic layout and holding of the crankshaft milling cutter
- Safe
Space-saving protective enclosure
- Quick
Quick and highly precise incident light measurement of the cutting tool edges, measuring mode »focus 360i«
- μm -accurate
Automatic and user-independent measuring procedures, highly precise measuring sensor for axial runout compensation

Software

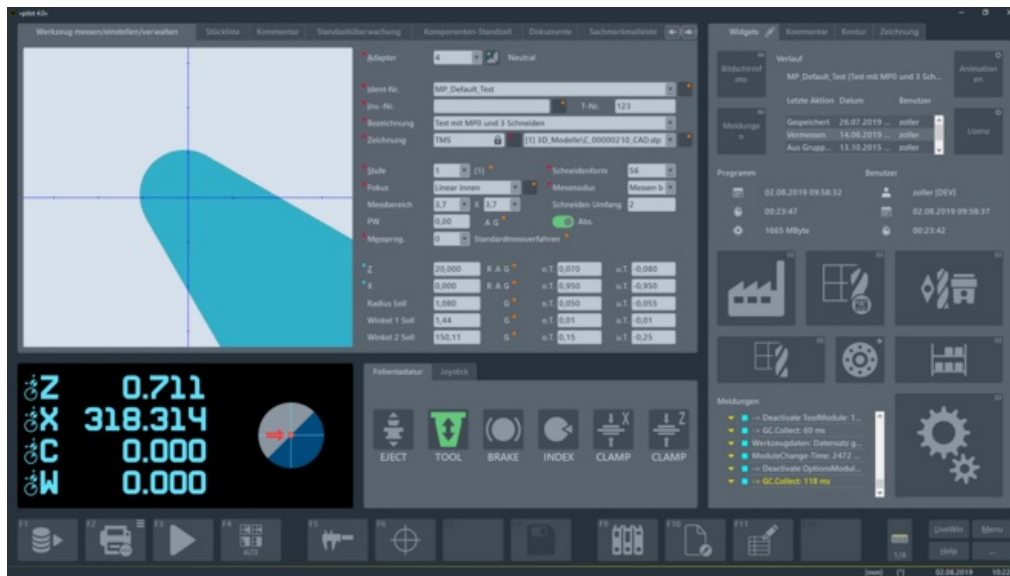

Modern design and even more features: The software for all-inclusive tool measurement

»pilot 4.0«

- Graphic rich, self-explanatory user interface
- All features are easily accessible
- Large click and touch areas
- Photorealistic input interface
- Dynamic crosshairs
- Self-explanatory function keys
- Automatic cutting edge shape recognition
- Automatic zero point monitoring
- Clear and precise cutting edge display and inspection
- Tool and adapter management
- Tool identification
- Test report output
- Data transfer to the machine tool and interfaces to external systems

and many other functions and options

► more

Technical data

»gemini«

Measuring range Z

150 mm (5.9 inch)

Ø

1000 mm (39.4 inch)

Measuring range X

500 mm (19.7 inch)

Note: Using adapters and attachment holders can reduce the indicated measuring range in some circumstances.

Measurement programs

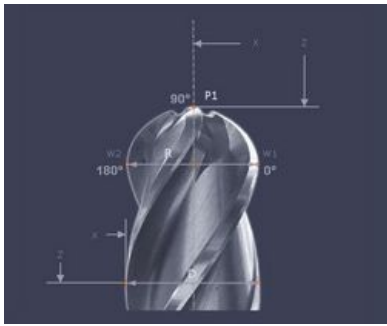

Conical Reamers in Snap Gauge Method

Measuring program for the measurement of tapered reamers with the snap gauge method.

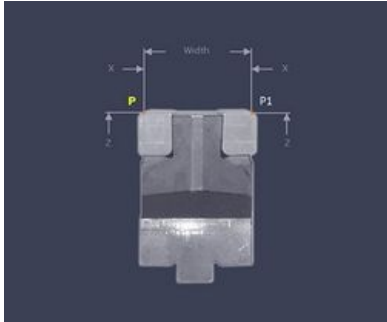

Conical Reamers

Measuring program for the measurement of tapered reamers without support bar .

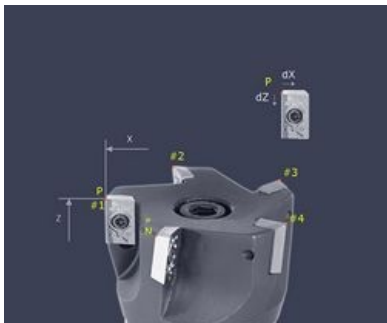

Single Cutting Edge Reamer - External Processing

Measuring program for the measurement of any parameters at the outer edge of single cutting edge reamers.

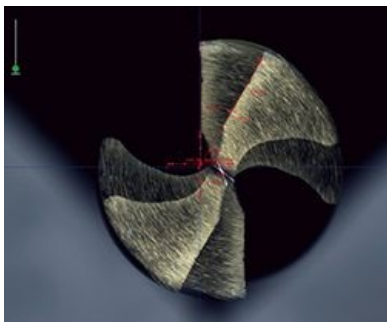

Theoretical Tip

Measuring program for the determination of the theoretical tip at tapered cutting tools over several measuring points.

Data Transfer



»zidCode«

The efficient solution for tool identification and data transfer

► to »zidCode«





RFID Chip

Fast way to the tool identification and data transfer

► to RFID Chip



Post Processor

Data output with DNC system prepared in a controller compatible manner

► to Post Processor





DataMatrix Code

Safe, quick and guaranteed error-free data transfer to your CNC machine

► to DataMatrix Code

120 Cutting Edges in just 80 seconds

Presetting crankshaft milling cutters and rotary or broaching tools quickly, easily and accurately is no problem thanks to the ZOLLER »gemini« presetting and measuring machine. The »gemini« measures 120 cutting edges in just 80 seconds with unmatched simplicity. The globally unique, fulling automatic measuring in measuring mode »focus360i« is a highlight of the proven ZOLLER image processing software »pilot 3.0«. The highly precise measuring sensor for axial runout compensation also makes cumbersome measuring equipment unnecessary. You profit from maximum quality for your workpieces, increasing productivity while maintaining seamless documentation. You have a more ergonomic workplace, where your tools can be preset easily and can be measured and checked automatically.

